

50th Anniversary



Ranger Tugs. Real Cruising.

Since its introduction, the *Ranger R21-EC* has earned a loyal following among enthusiasts who enjoy cruising at its classic best. And today it's even better, with a boatload of improvements from greater interior volume and higher speed, to more responsive handling and convenient storage spaces.

Owners of this popular vessel have always measured fuel use in pints per hour, not gallons. With a refined hull design, the new Ranger R21-EC delivers significantly higher speeds and even better economy, bringing more cruise destinations within easy reach.





And with a new cabin design that's eighteen inches longer and seven inches wider, there's room inside for pilot and companion seats, head, galley cabinet and a larger berth...greater comfort to make the trip all the more worthwhile.

Inspired by a traditional Bristol Bay trawler design, the Ranger R21-EC will never go out of style, ensuring both lasting appeal and maximum resale value. Easily trailerable, this boat rewards its owner with a level of versatility that few other cruisers can match.





Ranger Tugs R21-EC – Specifications

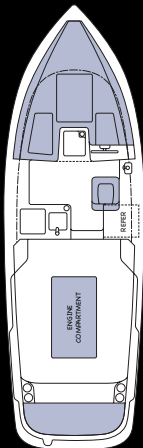

Length Overall	21' 0"	6.4m
Length on Optional Trailer	26' 0"	7.94m
Beam	6' 8"	2.03m
Draft	24"	.61m
Displacement	2,750 lbs	1,250 kg
Fuel Capacity	18 U.S. Gal	68.2 L
Water Capacity	10 U.S. Gal	37.9 L
Holding Tank Capacity	7.5 U.S. Gal	28.4 L
Bridge Clearance (w/o optional mast)	6' 8"	2.03m
Bridge Clearance (with optional mast)	10' 9"	3.28m



Quality Craftsmanship Since 1958